

HOW IT WORKS: CNC MILLS

What is a CNC Mill?



1a. Process

- Mill: A rotary tool to remove material from a workpiece by means of moving the part along the X, Y, or Z axis.
- CNC = computer numerical controller
- Code: A CNC mill with automatically mill the part more precisely and quickly than a human could.

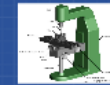

1b. Usefulness

- Simple parts can be made quickly and more precisely than a manual mill
- Complex parts can be machined out of a single workpiece instead of having to use multiple manufacturing processes



3. Getting Access

- Be a mechanical engineer trained in machine shop practices
- Know a friend who is certified and ask them to do it for you



2. Locations on Campus

1. Mechanical Engineering Machine Shop (MH C-109)
2. Formula SAE/ICE Garage (Below Gesling Stadium)



1c. Limitations

- Drill bit size and prototype size
- Cannot bore square-edged holes in the material
- Expensive
- Requires background in mathematics, engineering, and programs (creo parametric, solid works, etc.)

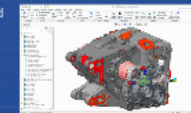

What is a CNC Mill?



3. Getting Access

2. Locations on Campus

1. Mechanical Engineering



Be a mechanical engineer trained in



1a. Process

- **Mill:** A rotary tool to remove material from a workpiece by means of moving the part along the X, Y, or Z axis.
- **CNC** = computer numerical controller
- **Code:** A CNC mill with automatically mill the part more precisely and quickly than a human could.

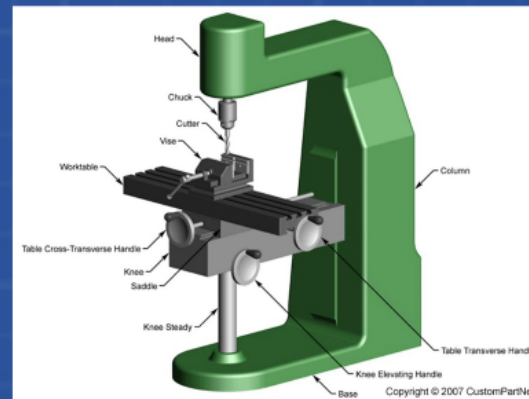

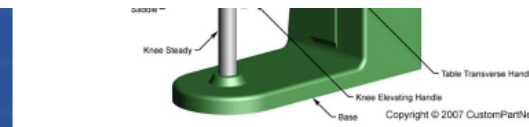

1b. Usefulness

- Simple parts can be made quickly and more precisely than a manual mill
- Complex parts can be machined out of a single workpiece instead of having to use multiple manufacturing processes



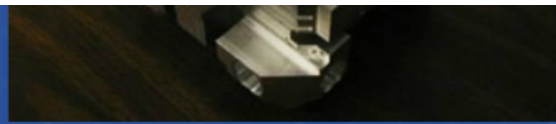
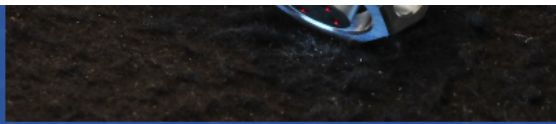

1c. Limitations

- Drill bit size and prototype size
- Cannot bore square-edged holes in the material
- Expensive
- Requires background in mathematics, engineering, and programs (creo parametric, solid works, etc.)

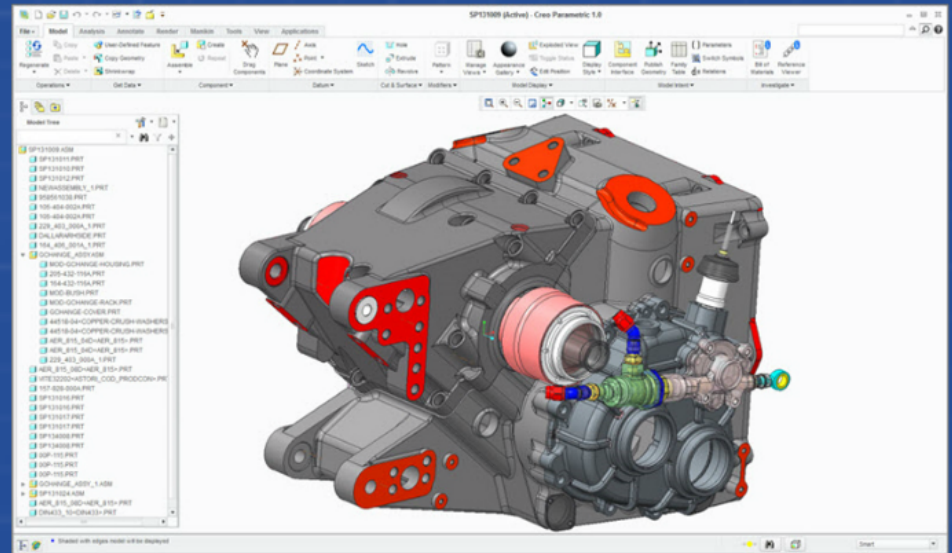

2. Locations on Campus

1. Mechanical Engineering Machine Shop (HH C-109)

2. Formula SAE/ICE Garage (Below Gesling Stadium)



3. Getting Access

- Be a mechanical engineer trained in machine shop practices
- Know a friend who is certified and ask them to do it for you

